



**SUVEDHA**

*Paradise*

2 and 3 BHK Luxury Flats

*Higher Quality of Living*



# SUVEDHA *Paradise*

From a builder who shares  
the same dreams of the buyer

Suvedha Paradise is an irresistible living option from Suvedha Builders & Developers, who owns a legacy of providing quality construction and living innovations in some of the choicest localities in Bengaluru. With over three decades and more projects, Suvedha has emerged as a synonym for quality, style and transparency. A rare blend of luxury, necessity and class- this is what makes every Suvedha project exceptional. The vision of Suvedha has been the same since beginning- straying away from convention and adding a new value and meaning to life.





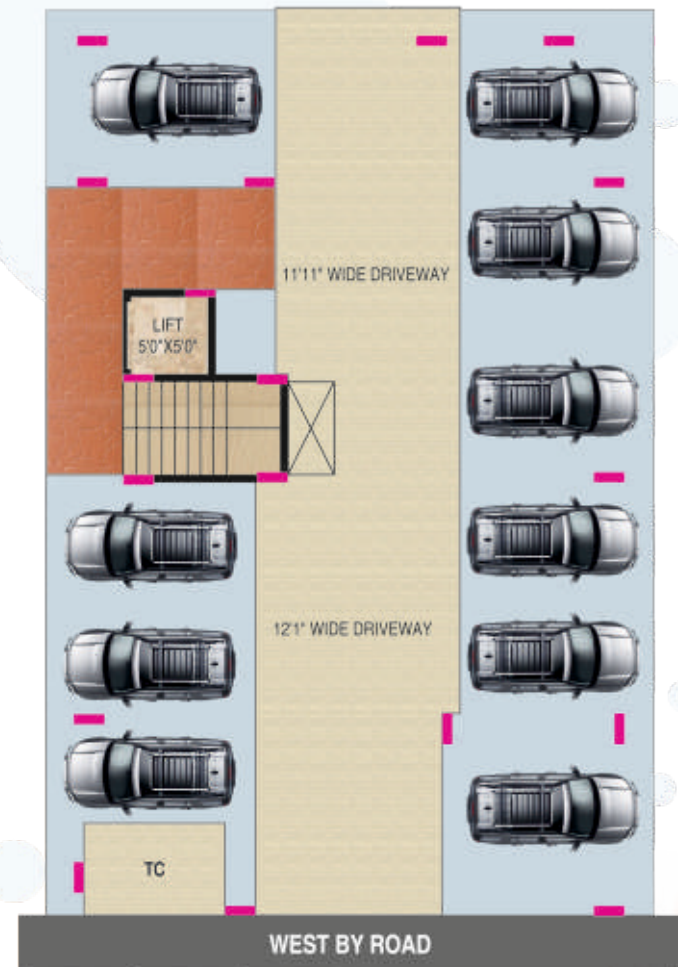

## Car Parking floor Plan



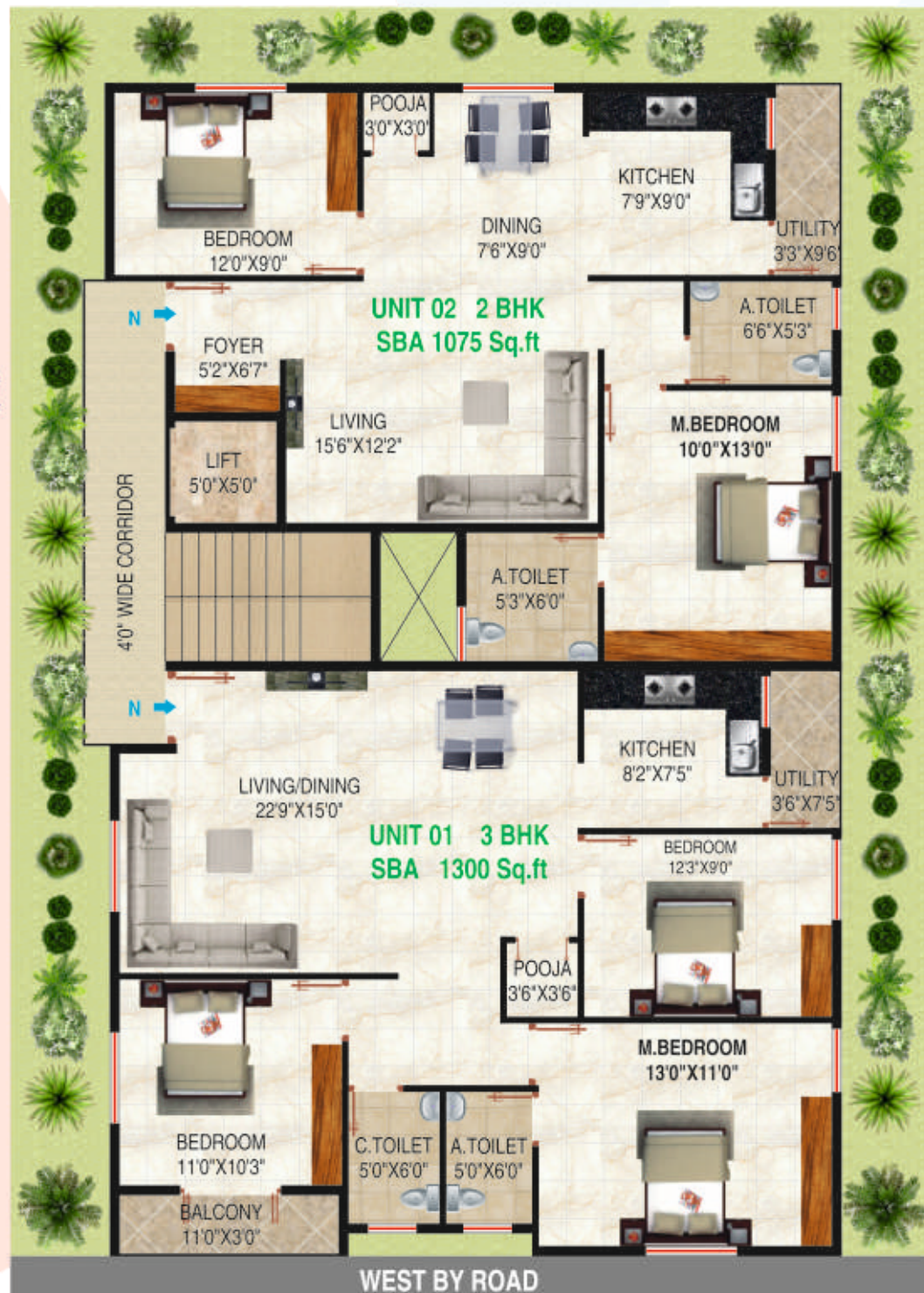

# SUVEDHA Paradise

## AREA STATEMENTS

SL. No.	FLOORS	SALEABLE AREA IN S.F.T. (APPROX.)	
1.	Ground Floor	G.F.1 1300	G.F.2 1075
2.	First Floor	F.F.1 1300	F.F.2 1075
3.	Second Floor	S.F.1 1300	S.F.2 1075
4.	Third Floor	T.F.1 1300	T.F.2 1075
5.	Fourth Floor	Fr.F.1 1300	Fr.F.2 1075



## 3 Dimensional views



### UNIT 01

North Facing, 3 BHK Flats

Area : 1300 Sft.



### UNIT 02

North Facing, 2 BHK Flats

Area : 1075 Sft.





# Specifications

## STRUCTURE

R.C.C framed structure designed for zone II regulations.

## WALLS

6" thick external walls and 4" thick internal walls of solid block masonry.

## FLOORING

- Vitrified tile flooring for all flats.
- Staircase and lobbies with granite flooring.

## DOORS

- Solid teak wood for main door.
- All other doors of flush wood with complete fittings.

## WINDOWS

Sal wood frames and shutters with safety grills.

## KITCHEN

Stainless steel sink on 30 mm granite platform, 3' height dadoo above platform.

Power point provision for drinking water purifier, refrigerator, cooking range and exhaust fans.

## TOILETS

Anti-skid ceramic tiles for flooring

Glazed tiles dadoo upto 7' height for toilet.

Sanitary fittings of Jaquar/CERA/Hindware or equivalent make.

Quality CP fixtures & mixers.

## PAINTING

Internal walls : Acrylic emulsion.

External walls : Weather proof Cement Based paint.

Doors & grills : Enamel paint.

Polish : Main door.

## ELECTRICAL

- Anchor wires.
- TV and telephone points in living and master bedrooms.
- Quality switches : Anchor/GM/equivalent

## CAR PARKING

- Stilt level parking.

## WATER SUPPLY

- Department supply & auxiliary, bore well supply.

# SUVEDHA *Paradise*



## Location Details

### SCHOOLS AND COLLEGES

- Auden Institute of Education : 1.1 Kms.
- Appolo National Public School : 1.2 Kms.
- Little Flower Public School : 1.7 Kms.
- Kanaka Colleg of Management : 450 Mts.
- PES College : 900 Mts.
- BMS College of Engineering : 1.2 Kms.

### HOSPITAL

- Prashanth Hospital : 800 Mts.
- Vinayaka Hospital : 850 mts.
- Meenakshi Hospital : 950 Mts.
- Motherwood Hospital : 950 Mts.





## Completed Projects



**SUVEDHA ELEGANT**, Srinivasnagar



**SWASTIK ELEGANCE**, V V Puram



**GALAXI ELITE**, BSK 3rd Stage



**SAI BALAJI ENCLAVE**, Bengaluru

## Ongoing Project



**SAI BALAJI PARADISE**  
Kathriguppe, Bengaluru

**SUVEDHA LUXURIA**  
Poorna Prajna Layout, Bengaluru



## Location Map



# SUVEDHA *Paradise*

Architect :



**Swan Design**

Architect and interior Design

Srinivasanagar, BSK 1st Stage,  
Bengaluru - 560 050.

Call : 77855 99971 / 72049 21463

[www.swandesignarchitects.com](http://www.swandesignarchitects.com)

Email : [ram@swandesignarchitects.com](mailto:ram@swandesignarchitects.com)



## SUVEDHA BUILDERS & DEVELOPERS

# 10, 1st Main, 1st Floor, Vivekanandanagar, BSK 3rd Stage,  
Bengaluru - 560 085. Email : [suvedhabuildersanddevelopers@gmail.com](mailto:suvedhabuildersanddevelopers@gmail.com)

Site office :

No. 6, Vivekanandanagar, Kathriguppe Main Road,  
BSK 3rd Stage, Bengaluru.

### Marketing Partner



*Destiny Promoters*

Website : [www.destinypromoters.in](http://www.destinypromoters.in)

Email : [sales@destinypromoters.in](mailto:sales@destinypromoters.in)

For More Details Contact

Phone : **+91 96066 66146**

This brochure is purely conceptual. It is by no means a legal document.

The promoters, developers and the architects reserve the right to add, delete or alter any specifications, elevation or areas mentioned herein. If required.

